

CITY OF VINELAND

RESOLUTION NO. 2018-_____

RESOLUTION AUTHORIZING THE EXECUTION OF A
THIRD AMENDMENT TO THE REDEVELOPMENT
AGREEMENT BY AND BETWEEN THE CITY COUNCIL
OF THE CITY OF VINELAND AS REDEVELOPMENT
ENTITY AND NEWCOMB MEDICAL ALLIANCE, LLC FOR
THE FORMER CAMPUS OF NEWCOMB HOSPITAL

WHEREAS, on August 3, 2015, the City Council of the City of Vineland as the Redevelopment Entity and Newcomb Medical Alliance Center, LLC, A New Jersey Limited Liability Company with offices located at 12 Crest Court North Halden, New Jersey, as the Redeveloper entered into a Redevelopment Agreement for the redevelopment of the former campus of Newcomb Hospital known as Block 4216, Lots 1, 2 and 3 on the City of Vineland tax map (Redevelopment Agreement); and

WHEREAS, Section 3.2(p) of the Redevelopment Agreement specifies that the Redeveloper will construct and fit out the EMT Station and the garage addition thereto, at the City's expense and in accordance with plans and specifications approved and subject to modification by the City. The cost to develop the EMS Station and construct the garage addition was to be estimated and negotiated between the parties; and

WHEREAS, the Redeveloper has met with representatives of the City and has received a proposal to construct and fit out the EMT Station and the garage addition thereto and the parties wish to amend the Redevelopers Agreement to include the proposal from Archetto Construction Inc. in the amount of \$2,180,425.00, which amount is found to be fair and reasonable; and

WHEREAS, City Council of the City of Vineland finds it to be in the best interest of the City to execute a Third Amendment to the Redevelopment Agreement to include the cost for the services specified in Section 3.2(p).

NOW THEREFORE BE IT RESOLVED by the Council of the City of Vineland , and as the Redevelopment Entity that the Council President is hereby authorized to execute the Third Amendment to the Redevelopment Agreement to amend Section 3.2(p) of the Redevelopment Agreement in accordance with the plans and specifications as attached hereto and made a part hereof.

Adopted:

President of Council

ATTEST:

City Clerk

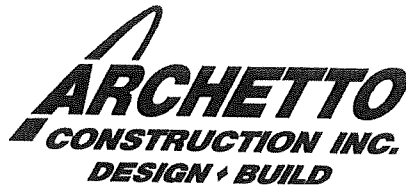

August 30, 2017

Newcomb Medical Alliance Center, LLC
12 Crest Court
North Haledon, NJ 07508

RE: **Vineland EMS Building**
Former Newcomb Medical Center
Vineland, NJ
Proposal #3-Revised

Attn: Mr. Angelo Danza

Dear Mr. Danza:

Archetto Construction, Inc. is pleased to submit the following proposal to renovate 8,456 SF of 1st story and 6,300 SF of basement at the former Newcomb Medical Center Building for use as the new Vineland EMS Headquarters. Our proposal is based on the Architectural Plans prepared by SPG3 Architect firm, last revised on 8/30/17 which was developed along with the EMS Director and Chiefs. Below please see scope of work:

General Conditions:

- Provide Architectural, Mechanical Engineering and Structural Engineering design for permitting. These design documents are suitable for Design Build turnkey construction only.
- Provide project Supervision, temporary site services, equipment, construction debris removal and final construction cleaning for the building.
- Provide (2) sets of closeout documents including As-Built Drawings, Warranty Documents and Equipment Manuals.

Existing Conditions:

- Provide selective demo for new roof penetrations and wall openings.
- Provide selective demolition of building components as shown on the plans.

Concrete and Masonry:

- Install garage foundation system including 12"x24" footings, 12" CMU foundation and rigid insulation 2' vertical and 2' horizontal.
- Install 12" split face CMU for garage walls and lift shaft. Split face CMU to be selected from Earthtone Colors.
- Provide slab on deck infills for existing 1st floor as required.
- Install 6" slab on grade with vapor barrier and WWF for garage area including concrete apron at overhead doors.
- Install (10) 6" pipe bollards for garage area with cover.
- Install CMU demising wall for basement and 1st floor to bottom of deck. (Lot line wall)
- Install foundation and CMU foundation wall at basement level where adjacent building demolition creates an opening.
- Install CMU exterior wall where tower building demolition creates opening.
- Provide masonry brick repair and pointing where required on Howard Street entrance.

1400 West Landis Avenue
Vineland, NJ 08360



"Our Business Is Building Yours"

Phone (856) 692-8781
Fax (856) 692-8466

August 30, 2017

Vineland EMS Headquarters
Proposal No. 3-Revised – Continued

Structural Steel:

- Install steel bar joist and deck for garage.
- Install steel lintels for door openings.
- Install framing and metal deck for floor infills.
- Install railings for new entrance (Door 100A) and Howard Street steps.

Carpentry:

- Provide light gauge metal stud partitions and blocking for office area.
- Provide roof framing and sheathing for material lift shaft roof.
- Provide infill framing and dens glass sheathing for exterior walls.
- Install fire rated sheathing for IT closet wall.
- Provide treated wood blocking for parapet walls at the roof.
- Cut roof openings and provide blocking for RTU's and exhaust.
- Provide laminate counters and casework in areas shown on plan.

Insulation:

- Provide R-11 sound batt wall insulation and R-19 above ceiling insulation for office area.
- Provide R-19 batt insulation on exterior walls.
- Provide EPDM roofing system over existing roof including tapered insulation to roof drains. R Value = 14.5.
- Provide EPDM roof system over garage including flat insulate equal to R-21.
- Provide aluminum coping and flashings for new roofing system.
- Provide scupper and downspout for material lift shaft.
- Provide gutter and downspout for garage.
- Provide EIFS system for exterior infills.
- Provide fire stopping at penetrations.
- Provide exterior caulking at existing masonry and new EIFS.

Doors and Windows:

- Provide medium stile aluminum storefront system for Door 100A and 130A. Door system to include standard rim panic device, tubular pull, standard duty closer and 1" insulated clear low-E glazing.
- Provide hollow metal doors and frames for doors 105, 140, 140A, 133, 132, (2) existing entrance at Howard street, door 150 and door 150A.
- Provide pre-finish solid core wood doors with birch veneer for office doors.
- Doors to include Grade 2 ADA hardware sets. (Access hardware to be provided by others). (Exhibit B)
- Provide sliding glass window for administration room.
- Provide (2) new and (4) replacement aluminum storefront window systems. Window assembly to be clear anodized aluminum, thermally broken frames with clear insulated Low-E glazing door system to include standard rim panic device, tubular pull, standard duty closer and 1" insulated clear Low-E glazing.
- Provide (4) insulated overhead doors with operators, one section of ½" insulated glass and door seals.

August 30, 2017

Vineland EMS Headquarters
Proposal No. 3-Revised – Continued

Finishes:

- Provide GWB on interior partitions and hard ceiling surfaces.
- Provide flooring including commercial grade carpeting, VCT, VCB, ceramic wall tile and ceramic floor tile.
- Provide 2x4 acoustical fissured ceiling tile and 15/16 Class A grid in office area.
- Provide FRP paneling at urinal and mop sink area.
- Provide painting including GWB surfaces, hollow metal doors & frames, garage walls, garage ceiling and concrete sealer for garage floors.
- Pressure wash basement and paint basement walls.

Specialties:

- Provide ADA restroom signage as required by code.
- Provide Bobrick or equal restroom accessories including (3) grab bar sets, toilet paper holders, (6) mirrors, (3) hand dryers, (3) clothes hooks, (2) napkin dispensers, (4) recess wall receptacles, (6) soap dispensers and (4) paper towel dispensers.
- Provide (3) powder coated, metal toilet partitions. Partitions to be floor mount, overhead braced.
- Provide (2) surface mounted and (3) semi-recessed cabinet mount fire extinguishers.
- Provide (30) 12” wide x 12” deep x 36” tall, 2-tier metal lockers with flat top and closed base in restroom area.
- Provide (2) wood benches with metal base in restroom area.
- Provide pre-manufactured aluminum wall hung canopy at main entrance. Finish TBD from clear anodized, white or bronze enamel.
- Install (25) custom room identification signs.
- Provide custom acrylic cut letter sign with LED illuminated channel letters above canopy. (Exhibit A)
- Provide “Customer Entrance” sign at entrance.
- Provide custom acrylic sign mounted to wall surface on the Howard Street side. Sign to be illuminated at light fixtures. (Exhibit A)
- Provide a full color LED display board below the wall signage on Howard Street. (Exhibit C)
- Provide Allowance of \$7,500 for supply and install of Day Room refrigerator, microwave, dishwasher, wall oven and ice machine as specified by the City of Vineland on 7/26/17. Provide electric and water hook ups as required. Provide modifications to Day Room including knee wall and counter. (Exhibit D)

Conveying Systems:

- Provide a hydraulic equipment lift with a 6’x8’ platform for basement storage. Lift to include 2,000 pound capacity, 2-level travel and access doors at both levels with safety devices.

Fire Suppression:

- Provide wet-type fire suppression system for fit-out including pendant style sprinklers for the 1st floor space, upright heads in basement space, upright heads in garage area and sidewall heads under garage doors. Fire suppression design assumes adequate City water pressure at riser.

August 30, 2017

Vineland EMS Headquarters
Proposal No. 3-Revised – Continued

Plumbing:

- Provide plumbing system for fit-out including PVC sanitary piping, copper domestic water piping, PVC vent piping, pipe insulation as per code, (5) waste closets, (6) lavatories, (1) urinal, (2) ADA showers, (1) mop sink, (1) laundry tray in garage, (2) hose stations in garage, shower and service sink in Decon Room, floor drains, single bowl sink in kitchen, HWH for facility and (2) oil/sand interceptors at garage.
- Provide gas piping for building,
- Provide roof drain piping for building.
- Install sump pump into existing pit for basement floor drains.

HVAC:

- Provide HVAC for office space including rooftop units with gas fired furnaces and approximately 19-tons of cooling.
- Provide IT room conditioning with a wall mount mini-split HVAC system and wall mount thermostat.
- Provide basement dehumidification system including ductwork to large storage rooms and condensate piping for unit.
- Provide garage heating including (2) gas fired tube heaters.
- Provide garage exhaust system controlled by CO/CO2 sensor including motorized dampers.
- Provide room exhaust fans for Restroom 117, Restroom 118, Janitors Closet 119, Restroom 135, EMS storage 131 Decon Room 132, and Restroom 100A.

Electrical:

- Provide building electric including:
 - 400 AMP 120/208 3-phase service panel.
 - 4" underground service lateral to pole, (2) 4" PVC conduits for telephone, (1) 2" PVC conduit for data. Service conduit figure at 60' from building to pole.
 - 100 KW emergency generator with weather proof enclosure to be mounted on existing vault lid.
 - Interior 2x4 fluorescent light fixture.
 - Emergency and exit fixtures as per code.
 - Fixtures, switches and outlets for fitout.
 - (14) telephone and data conduit drops.
 - Power wiring for rooftop units, mini-split unit, exhaust fans, hot water heater, electric range, gas fired tube heaters in garage, (4) overhead doors, lift and (2) cord reels for ambulance truck chargers.
 - Provide addressable fire alarm and detection system.

Sitework:

- Provide selective site demolition including concrete walks, curbs, brush removal, asphalt removal required for site improvements.
- Provide grading garage building sub-base, backfill and topsoil placement.
- Provide concrete curbing, handicap access, concrete walks, asphalt pavement, line stripping and signage.
- Provide security fence for generator area.
- Provide fertilizer and grass seed.
- Provide domestic water piping.

August 30, 2017

Vineland EMS Headquarters
Proposal No. 3-Revised – Continued

- Provide fire suppression water main and wet tap.
- Provide sanitary lateral to existing manhole. Sanitary to be gravity flow.
- Provide site irrigation system for Howard Street vegetation.
- Provide flag pole, base and light on Howard Street side of the building.

Data, Phone & Security:

- Install phone and data wiring as per the scope shown on Dave Guidarini proposal dated 6/23/17, (Exhibit B). This scope of work was provided to the subcontractors by the City of Vineland.
- Install access control and surveillance camera system as per the scope shown on Safe and Sound Security proposal (Exhibit B). This scope of work was provided to the subcontractors by the City of Vineland.

Please be advised that these two proposals were derived between the City of Vineland and the Subcontractors. Any changes to the scope of work will be handled as a change order to the project.

**Preliminary Proposal Amount: ----- \$2,180,425.00
(Two Million One Hundred Eighty Thousand Four Hundred Twenty-Five Dollars and No Cents)**

**This proposal is valid for fourteen (14) days.
Prevailing Wage Labor applied.

Archetto Construction reserves the right to modify our proposal as may be required by the final construction documents for permitting.

Exclusions:

1. Permit fees.
2. Bonding.
3. Utility fees or wet taps.
4. Fire pump for fire suppression. (Assumes city water pressure is adequate for system).
5. Furniture.
6. Ventilation hood or ansul system in kitchen.
7. Commercial kitchen.
8. Non-standard working hours (work to be performed during regular business hours – 7:30am to 3:30pm).
9. Any unforeseen or latent conditions not mentioned in this proposal.

Thank you for the opportunity to provide a proposal for your project. If you should have any questions, please contact our office.

Sincerely,

Nicholas A. Rehm, Vice President

EXHIBIT A

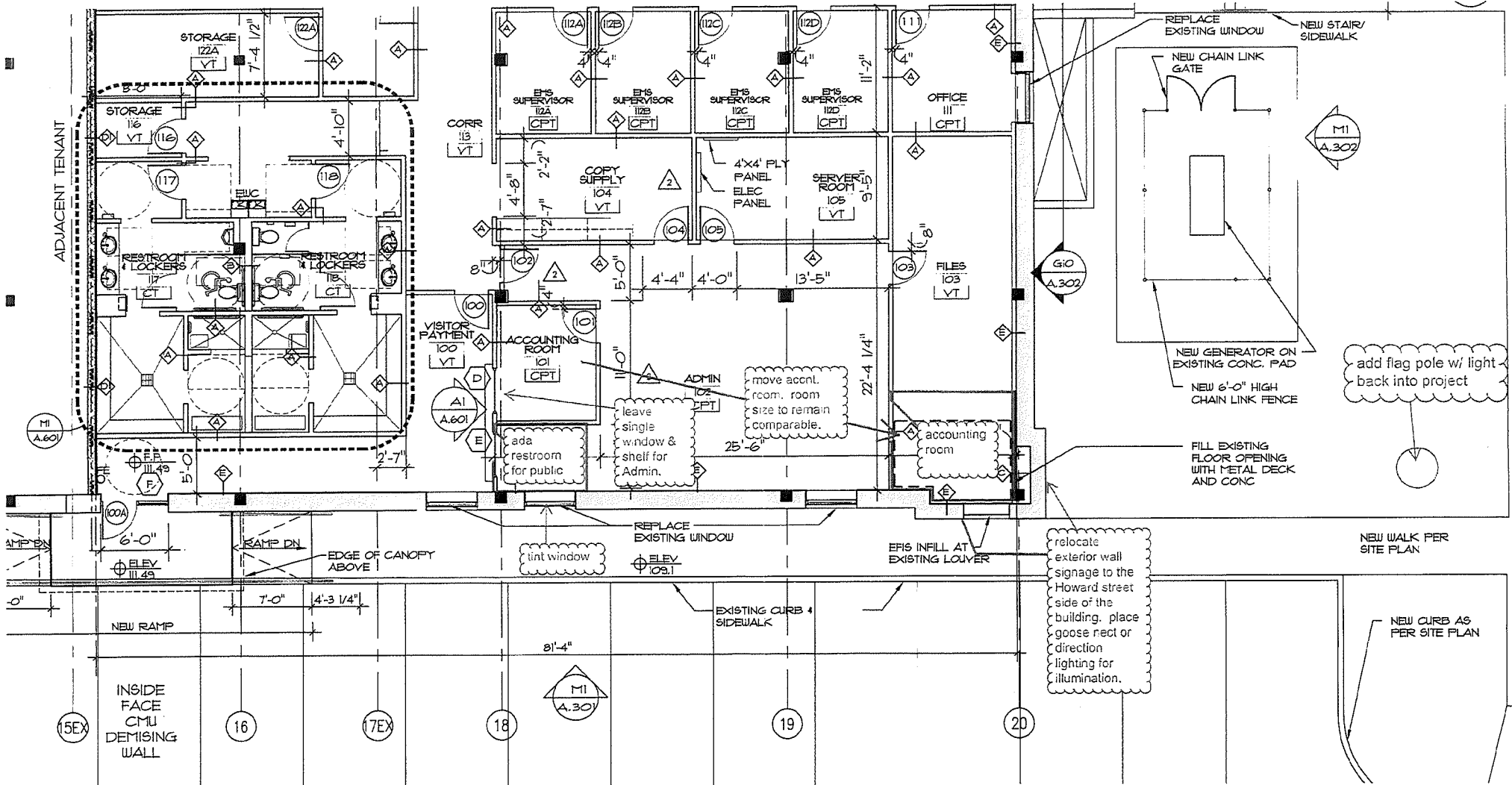

This plan will be incorporated into the Architectural plans once approved by the City.

W. J. ...
 1/25/17 ...
 ...

EXHIBIT B

Archetto Construction, Inc.

From: Terenik Victor [vterenik@vinelandcity.org]
Sent: Monday, June 26, 2017 9:53 AM
To: Archetto Construction, Inc.
Subject: RE: Vineland EMS Plans
Attachments: 20170626101443495.pdf

Brian,

Attached are the quotes for security and data/phone work and equipment. I scanned them all into one PDF file. The first two pages are for the Data/Phone cabling and equipment. The next two are for the security system and surveillance camera systems.

If you have any question please don't hesitate to call

Vic

Victor B. Terenik, Jr., CGCIO
Director Information Systems
City of Vineland
P.O. Box 1508
Vineland, NJ 08362
Phone: 856-794-4000 ext 4692
Fax: 856-405-4602
vterenik@vinelandcity.org

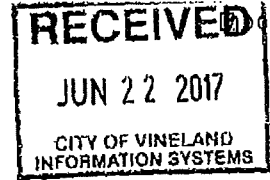

Dave Guidarini

Licensed, Bonded & Insured
 Electrical - NJ License No. 9027
 Mechanical Contractor
 1616 North East Avenue, Vineland, NJ 08360
 856-696-9399 - Fax - 856-696-2883
 Pager - 856-262-6050
 Industrial - Commercial - Residential
 60' Bucket Truck Service

06/23/2017

REF: Data and Phone Wiring for New EMS Station

General Contractor shall provide the following:

- All structural penetrations for wire way sleeves; GC shall supply and install all conduit sleeves; shall have connectors with fiber bushings on each end to provide physical protection of cabling.
- Lou will specify to GC the size of sleeves (most to be 4"), how many sleeves at each location, all sleeves will be sized for future use.
- GC will fire stop all exterior perimeters of all sleeves.
- GC will give Lou a key since when we work to pull wires, it is very difficult to re-setup the pulling area. This will amount to longer days in regard to the pulling of cables.
- If above work cannot be completed by General Contractor, we will complete the above at additional charge of time and material.

PS:

- Lou will fire stop space left inside of pipe sleeves after all wiring is installed.
- Provide all labor of electricians and data communications technicians (and material) to install all material listed on Page 2, and insurance to complete data and phone wiring at new EMS Center (old hospital). All work areas will be kept clean so as not to disrupt others.

TOTAL \$70,661.00

- 1 APC AR3300 Equipment Rack at MDF**
- 2 AP8941 switched pdu 30A units**
- 2 AP8930 switched pdu 110v units**
- 2 Ortronics 48 port cat6A patch panels**
- 90 Ortronics OR-TJ6A jacks [color - customer choice]**
- 3 Siemon M1-50 connecting blocks 66 type**
- 1 Chatsworth cable runway/angle support/mounting kit**
- 7000 ft 6A cable**
- 24 Ortronics 4 port wall plates/with blanks**
- All cables labeled/verified**
- 4 inch sleeves/with plastic ends provided by customer at all
firewalls and core drill floor locations**
- 3/4x4x8 Backboard paint flat black or your choice**
- All Labor and Equipment included in price**

**SAFE & SOUND SECURITY
991 S. DELSEA DRIVE
VINELAND, NJ 08360
856-696-7233
FAX 856-696-7811
FIRE LICENSE #P00504
BURGLAR LICENSE #34B0010780**

TO: City of Vineland- EMS Building

ATTN: Victor Terenik

RE: Access Control System

- 1- Three (3) Honeywell NetAX-4L1 to control four (4) access doors with power supply**
- 2- One (1) Honeywell NetAX-4S1**
- 3- Ten (10) HID-OMNY Class Card Readers**
- 4- Four (4) Card Readers with key pad**
- 5- Eight (8) Rutherford Door Strikes**
- 6- Two (2) Alarm Control- 1200 lbs Maglocks**
- 7- Two (2) Request to Exit Buttons**
- 8- Two (2) Request to Motion Detectors**

Total price installed including labor and material: \$ 26, 575.00

Note: This proposal is based on standard base labor

**SAFE & SOUND SECURITY
991 S. DELSEA DRIVE
VINELAND, NJ 08360
856-696-7233
FAX 856-696-7811
FIRE LICENSE #P00504
BURGLAR LICENSE #34B0010780**

TO: City of Vineland- EMS Building

ATTN: Victor Terenik

RE: Surveillance Camera System

- 1- One (1) LTS 16 Channel NVR with 16 IP capable-3 T bite hard drive**
- 2- Two (2) Outdoor LTS IP PTZ Cameras- Mod-PTZIP762X20IR, 2.1 MP, Full HD 1080P, Smart Tracking, 1920x 1080P @30fps, 4.7-94mm, 20x Optical Zoom, ½.8" CMOS, 10 IR LEDs@495ft, High POE-AC 24V.**
- 3- One (1) Indoor LTS PTZ Camera- Mod-PTZIP211X20-C, 1.3MP, 1280 x 720P @30fps, Ceiling & Flush mount.**
- 4- Six (6) Indoor Cameras- HD Turret TVI, 2.8-12mm Varifocal Lens, Matrix IR LED up to 131 ft, UTC Control to OSD Menu, 0.01 Lux-smart IR.**
- 5- One (1) Indoor Camera-Mod-LTCMHR6823D-Z, TVI Bullet 2MP 1080P 2.8-12mm Motorized Lens 42 IR to 131 ft.**
- 6- One (1) 9 channel Power Supply- Mod-DV-AT1209A-D9.**

Total price installed including labor and material: \$8,750.00

Note: This proposal is based on standard base labor

DIGITAL MESSAGE SIGNS

EXHIBIT C

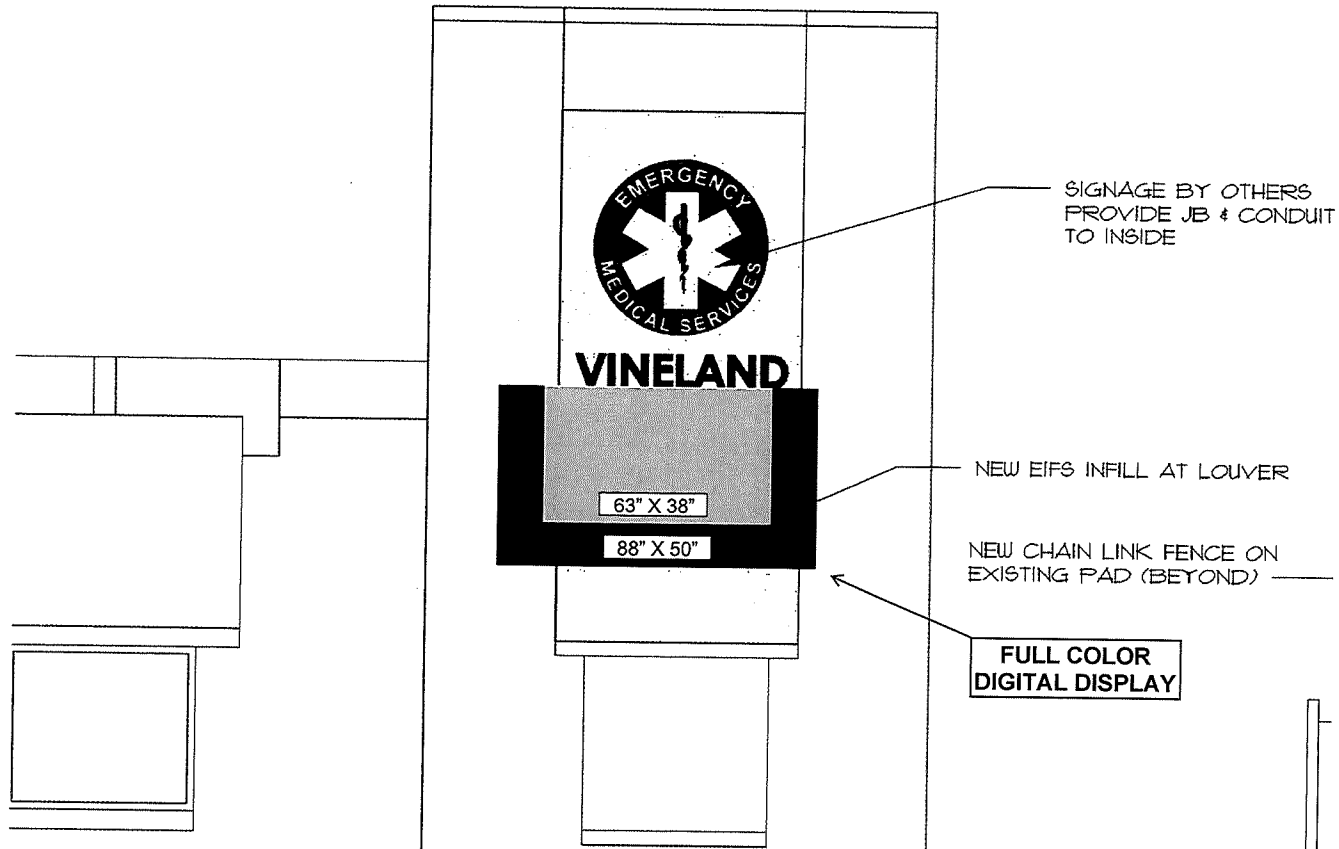

ARCHETTO CONSTRUCTION INC. DESIGN • BUILD	Customer: _____
	Address: _____
	Phone: _____
	Notes: _____
P: (856) 692-8781 F: (856) 692-8460	
PROJECT DETAILS:	

EXHIBIT C

Polaris 10mm 128x224 Single Sided Full Color LED Display

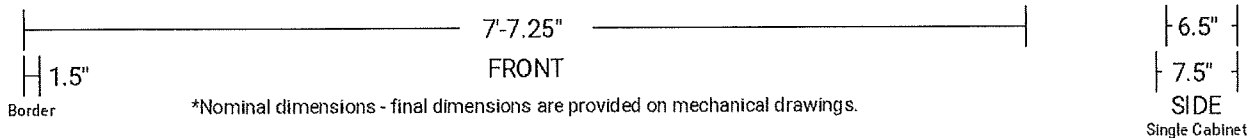
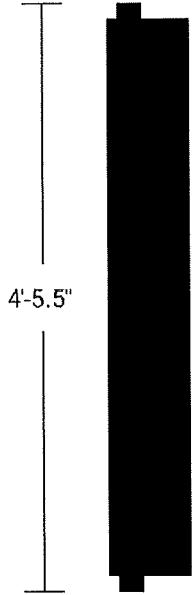
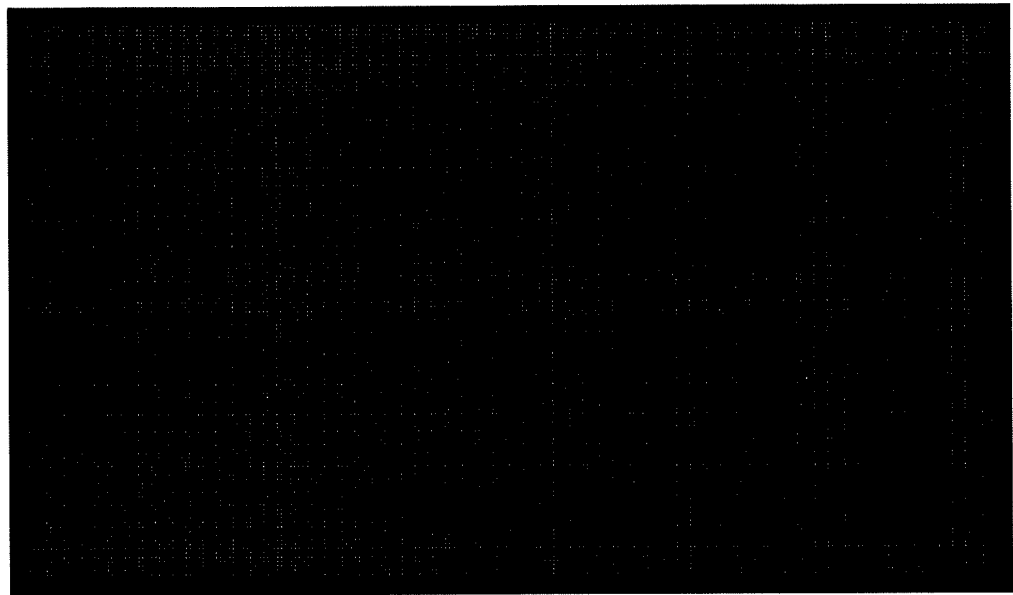

Display Specifications

Model:	Polaris
Color:	Full Color
Pixel Pitch:	10mm (0.39")
Matrix - pixel height:	128
Matrix - pixel width:	224
Sides:	Single Sided
Cabinet Type:	Hinged
Modular Design:	No
Communication Method:	Ethernet Cable
Controller:	Industrial PC
Total pixels:	28,672
Total LEDs:	86,016
Brightness:	> 10,000 nits
Number of colors:	281 quintillion
Virtual pixel enabled:	No
Horizontal/vertical viewing angle:	140/70
Software:	SignCommand.com
Frames per second:	60
Auto or manual dimming:	Included

Electrical Requirements

Requires 1 circuit at 20 amps.

Typical use (daytime):	1,199 watts
Typical use (nighttime):	240 watts
Maximum:	2,398 watts
Voltage:	240 volts
Max draw:	10 amps

Operating cost is approximately \$63 per month, assuming the average of daytime and nighttime use and a price of \$0.12 per kWh.

Display Dimensions

Nominal dimensions - final dimensions are provided on mechanical drawings.

Active display height:	4'-2.5" (50.5")
Active display width:	7'-4.25" (88.25")
Active display sq.ft.:	30.9 sq.ft.
Cabinet height:	4'-5.5" (53.5")
Cabinet width:	7'-7.25" (91.25")
Individual cabinet depth:	6.5"
Cabinet sq.ft.:	33.9 sq.ft.
Cabinet weight (approximate):	458 lbs.

Cabinet Options

Cabinet color:	Black (Glossy)
Vandal cover:	Not Included
Ventilation:	Rear

Text Capabilities

- 16 rows of 2.8" text
 - 12 rows of 3.5" text
 - 11 rows of 3.9" text
 - 8 rows of 5.1" text
 - 7 rows of 7.2" text *
 - 6 rows of 8.4" text *
 - 5 rows of 10.1" text *
 - 4 rows of 12.6" text *
 - 3 rows of 16.8" text *
 - 2 rows of 25.2" text *
 - 1 row of 50.4" text *
- * Using Windows font.

Graphics Capabilities

GIF, JPG, BMP, AVI, MPEG, WMV, SWF

EXHIBIT D

3'6" door here

Remove door & relocate

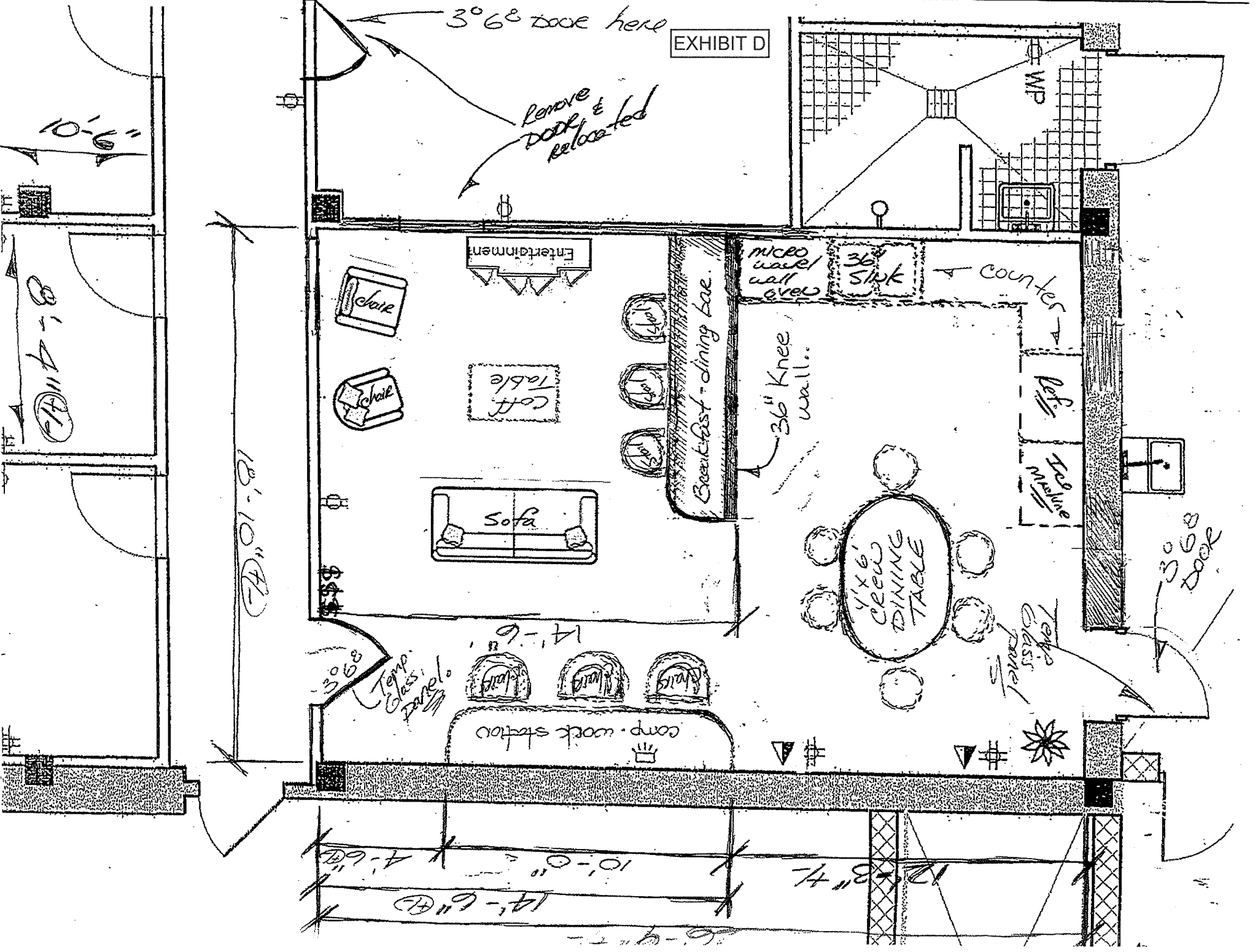

10'-6"

8'-4"
14'-6"

18'-10"
14'-6"

3'0" door
Temp. Glass Panel

comp. work station

Entertainment

chair

chair

Coff. Table

sofa

Breakfast-dining bar.

36" Knee wall.

Micro wave wall oven

4'x6' CREW DINING TABLE

Temp. Glass Panel

36" Sink

Left

Right

Temp. Glass Panel

3'0" door

10'-0"
4'-6"

14'-6"

12'-3 1/4"

6'-9"

EXHIBIT D

GDT655SGJ/SMJ/SSJ/SBL

GE Appliances Stainless Steel Interior Dishwasher with Hidden Controls

DIMENSIONS AND INSTALLATION INFORMATION (IN INCHES)

ELECTRICAL RATING

Voltage AC.....	120
Hertz.....	60
Total connected load amperage.....	7.2
Calrod® heater watts max.....	415/800

For use on adequately wired 120-volt, 15-amp circuit having 2-wire service with a separate ground wire. This appliance must be grounded for safe operation.

INSTALLATION INFORMATION: Before installing, consult installation instructions packed with product for current dimensional data.

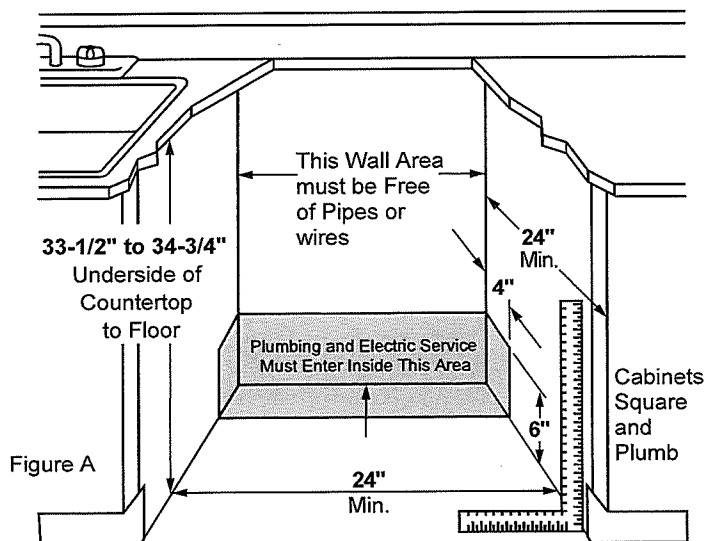
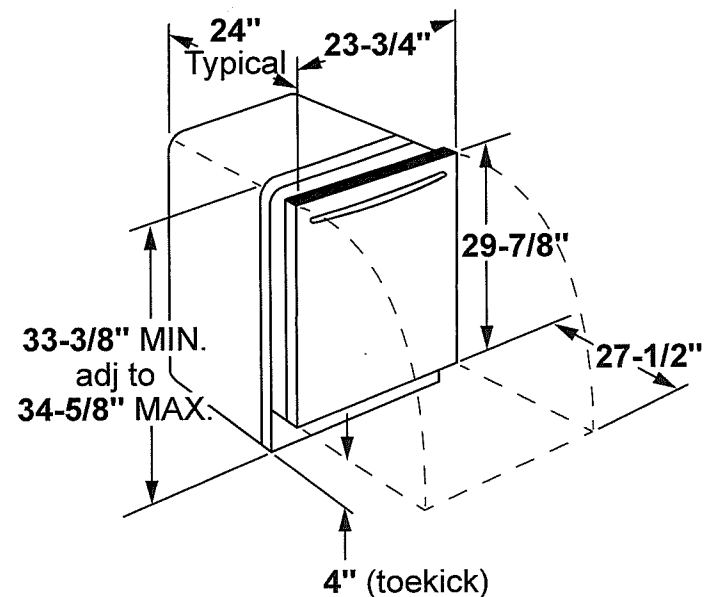

For answers to your Monogram, GE Café™ Series, GE Profile™ Series or GE Appliances product questions, visit our website at geappliances.com or call GE Answer Center® Service, 800.626.2000.



Listed by Underwriters Laboratories



As an ENERGY STAR® partner, GE has determined that this product meets the ENERGY STAR guidelines for energy efficiency.

GDT655SGJ/SMJ/SSJ/SBL

GE Appliances Stainless Steel Interior Dishwasher with Hidden Controls

FEATURES AND BENEFITS

Bottle Jets - Clean hard-to-reach areas inside tall items with dedicated jets integrated into the upper rack that shower water deep inside for the ultimate clean

Easy touch adjustable upper rack with 2 Stem Safe shelves - Quickly adjust the upper rack 2 inches up or down to accommodate tall glassware and 10 ½" plates with plenty of room in the bottom rack for large platters and cookie sheets

Piranha™ hard food disposer with removable filter - To ensure consistently clean items, this stainless steel blade rotates at 3,600 RPM to pulverize food particles and helps to prevent large particles from clogging the wash arms

Full-extension smooth-glide upper rack - Loading and unloading is smooth and simple with a durable rack that fully extends on ball bearings

Hidden vent with fan dry - Dishes dry quickly and efficiently with a fan that extracts moisture from the interior

GE's most advanced wash system - Consistently clean and dry dishes are ensured with GE's most advanced wash system, featuring 65% more wash power.* *Wash power delivered to each rack. Compared to previous GE models.

Lower rack multi-position, fold-down tines - Configure racks to fit your dishes with adjustable loading options including multi-position, fold-down tines

Floor Protect - Uncommon leaks can be easily detected and contained

3-piece silverware basket - Table-ready silverware is assured with a three-piece basket that can divide and separate for convenient placement

46 dBA - Motor runs quietly to keep kitchen peaceful

Model GDT655SSJSS - Stainless steel

Model GDT655SGJWW - White

Model GDT655SGJBB - Black

Model GDT655SMJES - Slate

Model GDT655SBLTS - Black Stainless

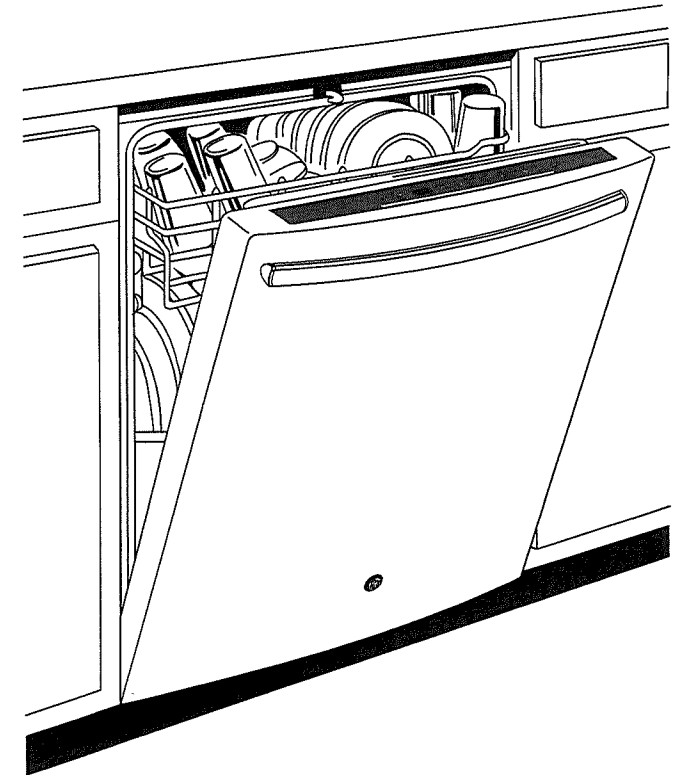

EXHIBIT D

PWE23KMK/KSK

GE Profile™ Series ENERGY STAR® 23.1 Cu. Ft. Counter-Depth French-Door Refrigerator

DIMENSIONS AND INSTALLATION INFORMATION (IN INCHES)

Overall Dimensions	Height to top of door (in.) A	70-1/2
	Height to top of hinge (in.) B	69-7/8
	Height to top of case (in.) C	69
	Case depth without door (in.) D	24-3/8
	Case depth less door handle (in.) E	28-3/4
	Case depth with door handle (in.) F	31-1/4
	Depth with fresh food door open 90° (in.) G	43-3/8
	Width (in.) H	35-3/4
	Width with door open 90° inc. door handle (in.) I	44-5/8
Air	Each side (in.)	1/8
	Top (in.)	1
	Back (in.)	2

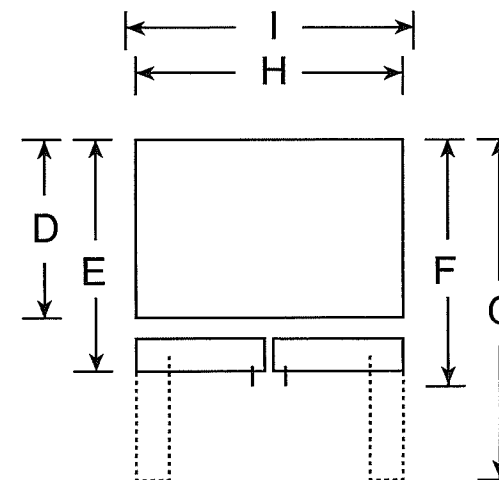
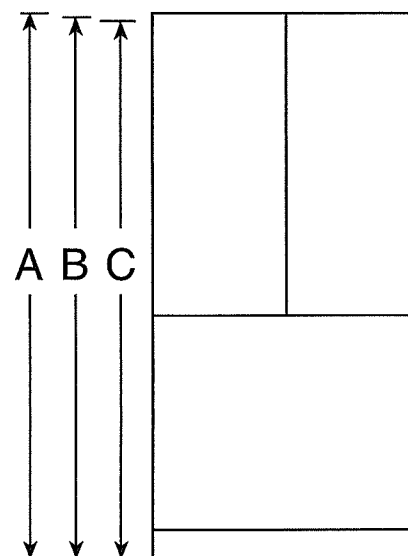

For answers to your Monogram, GE Café™ Series, GE Profile™ Series or GE Appliances product questions, visit our website at geappliances.com or call GE Answer Center® Service, 800.626.2000.



Listed by
Underwriters
Laboratories



As an ENERGY STAR® partner, GE has determined that this product meets the ENERGY STAR guidelines for energy efficiency.

PWE23KMK/KSK

GE Profile™ Series ENERGY STAR® 23.1 Cu. Ft. Counter-Depth French-Door Refrigerator

FEATURES AND BENEFITS

Counter-depth design - Offers a built-in look by fitting nearly flush with surrounding cabinetry

Internal water dispenser - Delivers filtered water with one touch

Full-width, electronic temperature-controlled drawer with colored LED lights - 3 accurate settings deliver the optimal temperature for your favorite foods, while colored lights indicate the chosen setting

TwinChill™ evaporators - Separate climates in the fresh food and freezer sections help keep foods fresh

Advanced water filtration uses RPWFE replacement filter - Reduces trace pharmaceuticals from water and ice* (* Removes 98% of ibuprofen, atenolol, fluoxetine, progesterone and trimethoprim. These pharmaceuticals are not necessarily in all users' water)

Showcase LED lighting - Positioned throughout the interior and under fresh food doors to spotlight foods inside the refrigerator and in the freezer

Quick Space shelf - Functions as a normal full-sized shelf when needed and easily slides down for instant storage flexibility

Model PWE23KMKES - Slate

Model PWE23KSKSS - Stainless steel

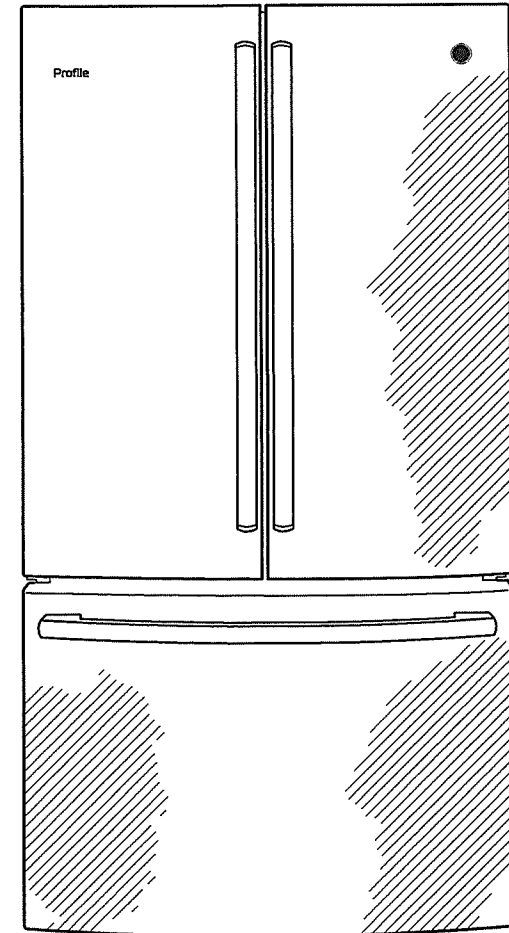

As an ENERGY STAR® partner, GE has determined that this product meets the ENERGY STAR guidelines for energy efficiency.



Profile™

EXHIBIT D

JES2251SJ – GE Profile™ 2.2 Cu. Ft. Capacity Countertop Microwave Oven

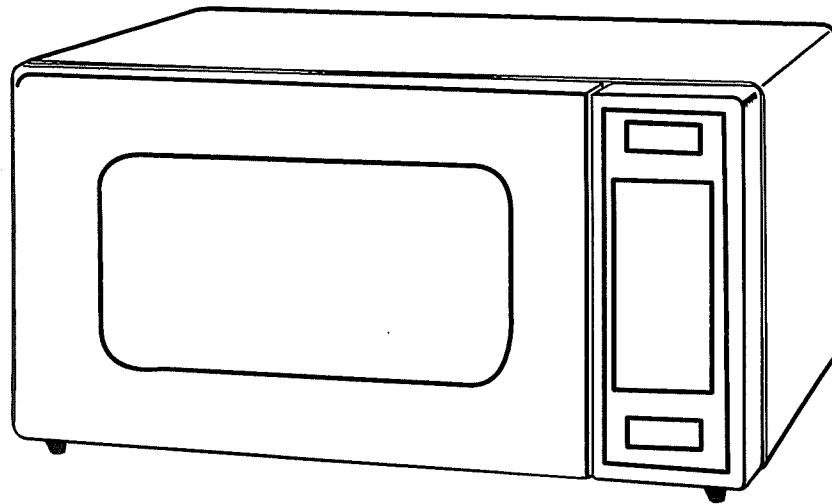

Exterior Dimensions* (in inches)	
W x H x D	24-1/11 x 13-25/32 x 19-13/32

*Height includes feet.

This unit designed to be placed on countertop.



For answers to your Monogram,® GE Profile™ or GE® appliance questions, visit our website at ge.com or call GE Answer Center® service, 800.626.2000.



Profile™

JES2251SJ – GE Profile™ 2.2 Cu. Ft. Capacity Countertop Microwave Oven

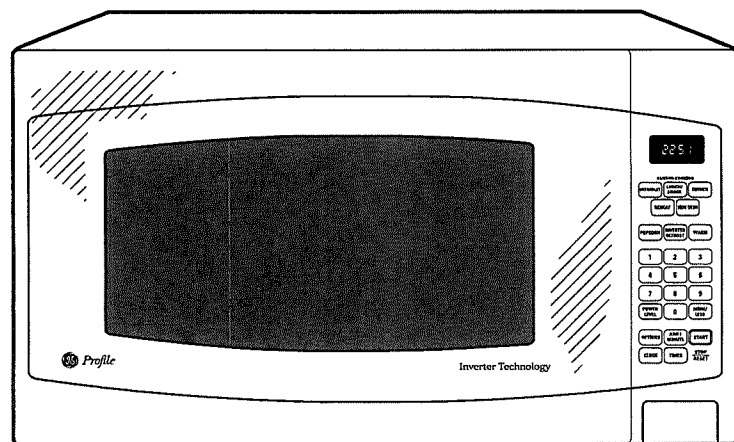

Features and Benefits

- 2.2 cu. ft. capacity – 1200 watts (IEC-705 test procedure)
- Inverter Technology – Consistent heat helps prevent overcooked edges and surfaces
- Sensor cooking controls – Automatically adjust the time and power for perfect cooking results
- Auto and Time Defrost – Automatically defrosts for a specified amount of time
- Turntable – Continually rotates food to ensure even cooking
- Child lock out – Enables you to lock the keypad to prevent the oven from being accidentally started
- Instant On Controls – Allow quick, one-touch cooking and reheating
- Model JES2251SJ – Stainless steel

EXHIBIT D

JT3000SF

GE 30" Built-In Single Wall Oven

DIMENSIONS AND INSTALLATION INFORMATION (IN INCHES)

MOST 30" WALL CABINETS CAN BE USED WITH THIS UNIT.

NOTE: These ovens are not approved for stackable installations. Cabinets installed adjacent to wall ovens must have an adhesion spec of at least a 194°F temperature rating.

Door handle protrudes 3" from door face. Cabinets and drawers on adjacent 45° and 90° walls should be placed to avoid interference with the handle.

Electric wall ovens are not approved for installation with a plug and receptacle. They must be hard wired in accordance with installation instructions.

INSTALLATION INFORMATION:

Before installing, consult installation instructions packed with product for current dimensional data.

Side-by-side installations require at least 2" between cutouts.

KW RATING	
240V	4.2
208V	3.2
BREAKER SIZE	
240V	20 Amps
208V	20 Amps

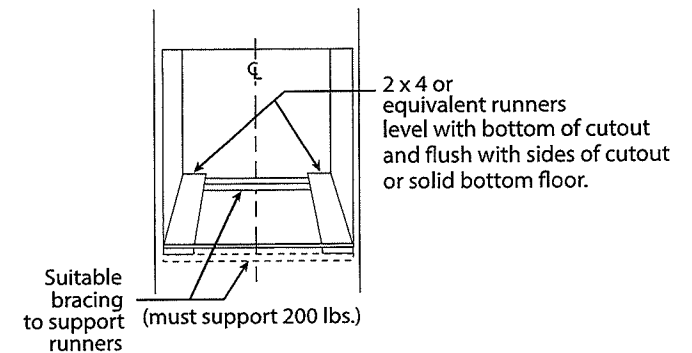
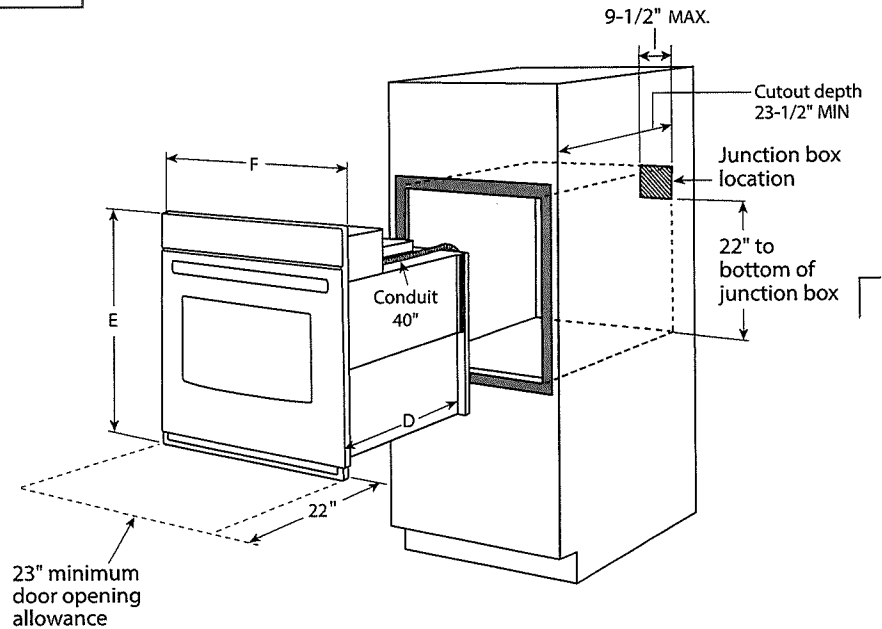
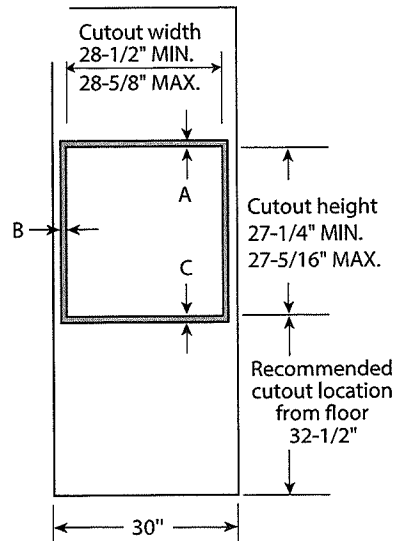

JT3000	
Cabinet	30"
A – Overlap of oven at top of cutout	1"
B – Overlap of oven over side of edges of cutout	3/4"
C – Overlap of oven at bottom of cutout	1-1/4"
Oven	
D – Install depth	23-1/2"
E – Overall height with trim	28-5/8"
F – Overall width	29-3/4"



For answers to your Monogram, GE Café™ Series, GE Profile™ Series or GE Appliances product questions, visit our website at geappliances.com or call GE Answer Center® Service, 800.626.2000.



Listed by Underwriters Laboratories



JT3000SF

GE 30" Built-In Single Wall Oven

OPTIONAL UNDERCOUNTER DIMENSIONS AND INSTALLATION INFORMATION

NOTE: 36" ribbon cooktop are approved for use over GE 30" single wall ovens and warming drawers. 30" ribbon cooktops are approved for use over 30" and GE 27" single wall ovens and warming drawers. Refer to cooktop and wall oven installation information packed with products for current dimensional data.

Note: Door handle protrudes 3" from door face. Cabinets and drawers on adjacent 45° and 90° walls should be placed to avoid interference with the handle.

Installation information: Before installing, consult installation instructions packed with products for current dimensional data and for alternate installation options.

ELECTRIC WALL OVENS ARE NOT APPROVED FOR INSTALLATION WITH A PLUG AND RECEPTACLE. THEY MUST BE HARD WIRED IN ACCORDANCE WITH INSTALLATION INSTRUCTIONS.

Gas or electric cooktops may be installed over this oven. See cooktop installation instructions for cutout size. See label on top of oven for approved cooktop models.

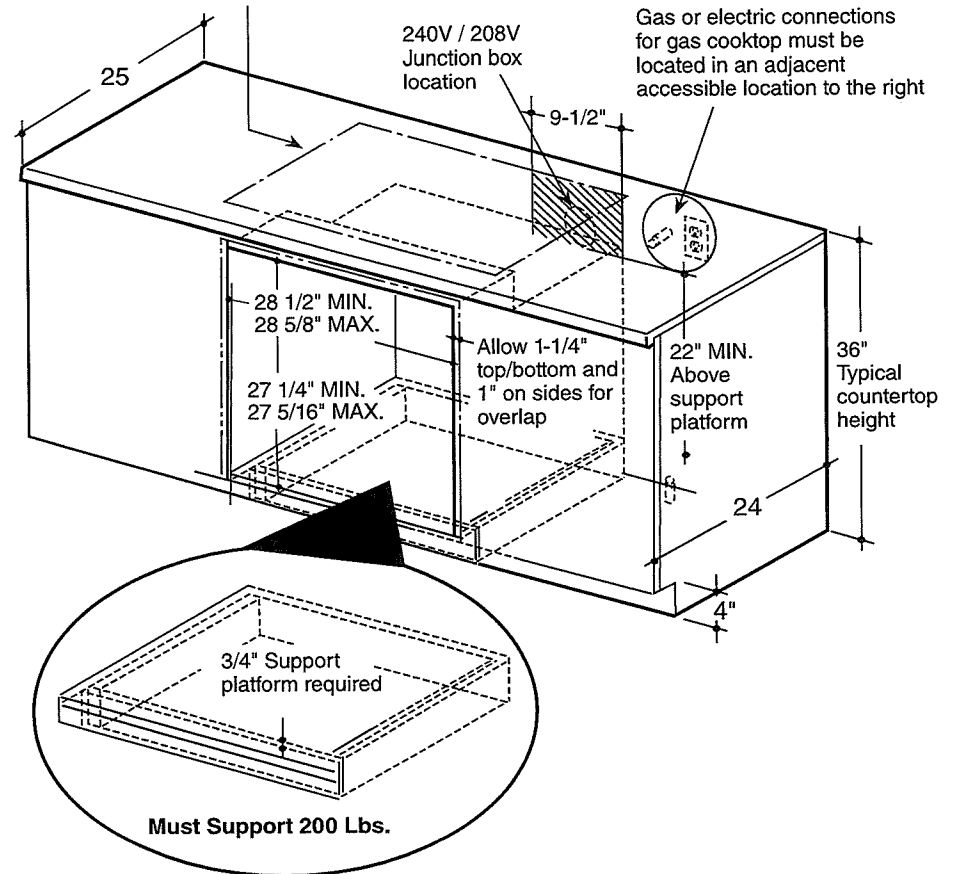

For answers to your Monogram, GE Café™ Series, GE Profile™ Series or GE Appliances product questions, visit our website at geappliances.com or call GE Answer Center® Service, 800.626.2000.

EXHIBIT D

JT3000SF

GE 30" Built-In Single Wall Oven

FEATURES AND BENEFITS

Self-clean with steam clean option – Clean your oven the way you want

Self-clean heavy-duty oven racks – Conveniently clean your oven and racks together

Ten-pass bake element – Even baking is assured with heat that covers more surface area

Eight-pass broil element – Get full broil coverage and even browning from edge to edge

5.0 cu. ft. oven capacity – Cook more dishes at once

Black gloss oven interior – Enjoy a clean and sleek appearance

Electronic touch controls – Confidently operate the oven with one easy touch

Hidden bake – Make cleanup easy by eliminating hard-to-reach areas

Audible preheat signal – Know when the oven is ready

Certified Sabbath mode – Prepare foods by kosher standards

Model JT3000SFSS – Stainless steel

GUARANTEED FIT

Replacing a similar wall oven from GE or another brand? GE wall ovens are guaranteed for an exact fit to make replacement easy

Visit geappliances.com for more info

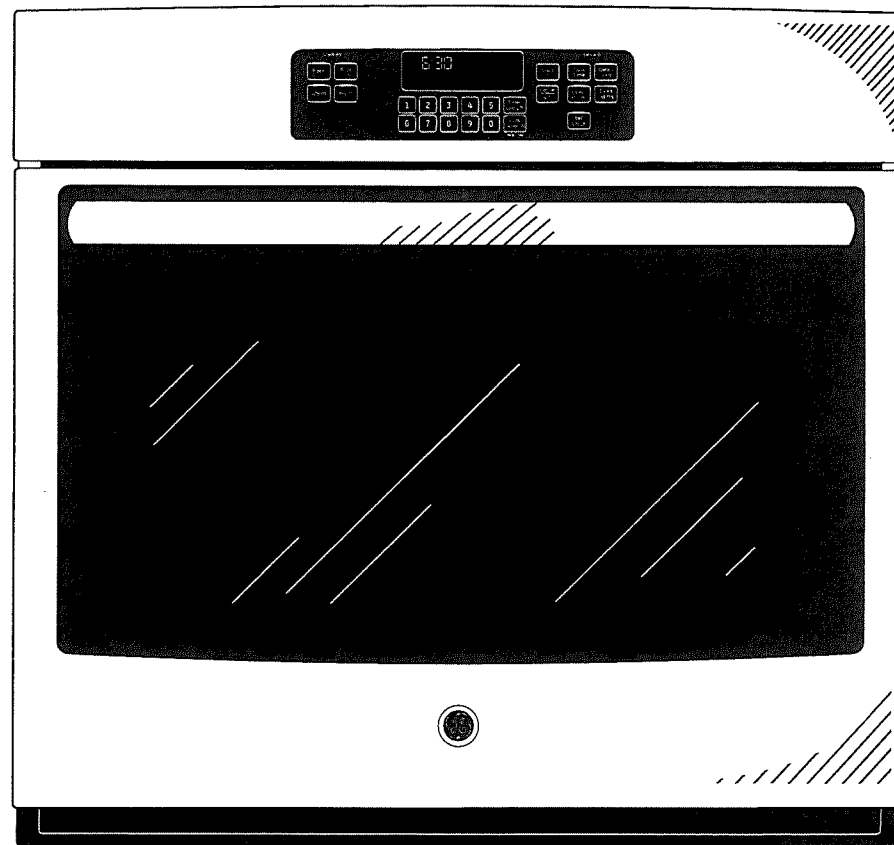

NEO™ 140/190 Undercounter Ice Machines

Models

- | | | | |
|-----------------------------------|-----------------------------------|-----------------------------------|-----------------------------------|
| <input type="checkbox"/> UR-0140A | <input type="checkbox"/> UD-0140W | <input type="checkbox"/> UY-0140W | <input type="checkbox"/> UD-0190A |
| <input type="checkbox"/> UD-0140A | <input type="checkbox"/> UY-0140A | <input type="checkbox"/> UR-0190A | <input type="checkbox"/> UY-0190A |



U-140 / U-190



- Ranging from 140 lbs. (64 kg) to 190 lbs. (79 kg) daily ice production
- Only 26" (66.04 cm) wide, 28.00" (67.31 cm) deep, and 38.50" (82.55 cm) high on 6" (15.24 cm) legs
- Up to 90 lb. (40.8 kg) ice storage capacity

NEO undercounter ice machines are designed to provide ice right where you need it – within reach. Improvements in **Performance**, **Intelligence** and **Convenience** make your ice machine easy to own and less expensive to operate.

Performance – NEO produces more ice than ever before while using less water and energy. The storage bin provides industry leading capacity.

Intelligence – NEO provides feedback with full bin and service indicators. Delay function allows you to pause your machine for slow periods or days when you're closed.

Convenience – NEO offers a forward-sliding storage bin for easy access to refrigeration components without having to move the entire ice machine. Smooth, sealed food-zone with removable water trough, distribution tube, and damper door for faster cleaning. AlphaSan added to key internal components.

Available **LuminIce™ Growth Inhibitor** extends cleaning intervals by reducing yeast and bacteria growth keeping your ice machine cleaner, longer.



Specifications

<p>BTU Per Hour:</p> <p>U-140: 2,150 (average) 2,600 (peak)</p> <p>U-190: 2,150 (average) 2,600 (peak)</p> <p>Compressor:</p> <p>Nominal rating: .42 HP</p> <p>Cupra-Nickel Condenser: (Water-cooled models) Adds protection from corrosive water elements.</p>	<p>Operating Limits:</p> <ul style="list-style-type: none"> • Ambient Temperature Range: 40° to 110°F (4.4° to 43.3°C) • Water Temperature Range: 45° to 90°F (4.4° to 32.2°C) • Water Pressure Ice Maker Water In: Min. 20 psi (137.9 kPa) Max. 80 psi (551.1 kPa) • Condenser Inlet Water In: (Water-cooled only) Min. 20 psi (137.9 kPa) Max. 150 psi (1,034.2 kPa)
---	--

Ice Machine Electric

Power Cord:
115/60/1 ice machines are factory pre-wired with a 6' (180 cm) power cord and NEMA 5-15P-plug configuration. 208-230/60/1 ice machines are factory pre-wired with a 6' (180 cm) power cord only, no plug is supplied.

Total Amps:
U-140: 115/60/1: Air-cooled and Water-cooled: 5 amps
208-230/60/1: Air-cooled and Water-cooled: 2.5 amps

U-190: 115/60/1: Air-cooled: 6 amps
208-230/60/1: Air-cooled: 2.5 amps

Maximum fuse size:
Air-cooled and Water-cooled: 15 amps
HACR-type circuit breakers can be used in place of fuses.

Ice Shape



Half Dice
3/8" x 1 1/8" x 7/8"
(.95 x 2.86 x 2.22 cm)



Dice
7/8" x 7/8" x 7/8"
(2.22 x 2.22 x 2.22 cm)



Regular
1 1/8" x 1 1/8" x 7/8"
(2.86 x 2.86 x 2.22 cm)



COMPANY WITH
QUALITY SYSTEM
CERTIFIED BY DNV
= ISO 9001:2008 =



NEO™ 140/190 Undercounter Ice Machines

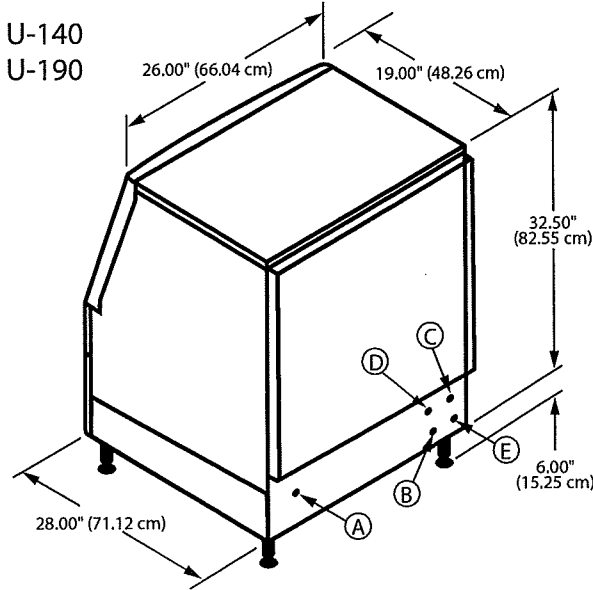

Installation Note Recommended clearance for top, sides, and back is 5" (12.7 cm) however, there is no minimum clearance required.

- (A) Electrical Entrance
- (B) 3/8" (0.95 cm) F.P.T. Ice Making Water Inlet
- (C) 1/2" (1.27 cm) F.P.T. Minimum Water Condenser Outlet (water-cooled units)
- (D) 3/8" (0.95 cm) F.P.T. Water Condenser Inlet (water-cooled units)
- (E) 1/2" (1.27 cm) F.P.T. Ice Bin Drain

Specifications

Model	Ice Shape	Ice Production 24 Hours				Power kWh/ 100 lbs. @ 90°/70°F 32°/21°C	Potable water usage gal/100 lbs. Ice @90/70°F	ENERGY STAR*
		70°Air/50°F Water 21°Air/10°C Water	90°Air/70°F Water 32°Air/21°C Water					
UR-0140A	regular	122 lbs	59 kg	90 lbs	41 kg	11.3	23.3	★
UD-0140A	dice	129 lbs	59 kg	95 lbs	43 kg	11.1	24.4	★
UD-0140W	dice	135 lbs	61 kg	104 lbs	49 kg	9.4	23.8	NA
UY-0140A	half-dice	132 lbs	60 kg	95 lbs	43 kg	11.1	24.9	★
UY-0140W	half-dice	126 lbs	57 kg	104 lbs	45 kg	9.4	22.9	NA
UR-0190A	regular	188 lbs	85 kg	133 lbs	60 kg	8.7	21.3	★
UD-0190A	dice	198 lbs	90 kg	140 lbs	64 kg	8.4	23.9	★
UY-0190A	half-dice	193 lbs	88 kg	140 lbs	64 kg	8.3	21.6	★

Water-cooled Condenser: 185 gal. / 700 liters

Water-cooled models are excluded from ENERGY STAR qualification.

Air Flow

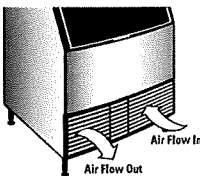

Air in right, air out left, no side vents. Great for installation under countertops and next to other equipment.

Removable Bin

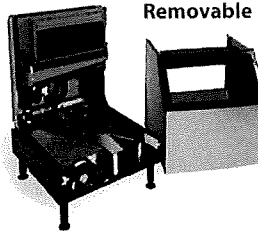

Air Filter

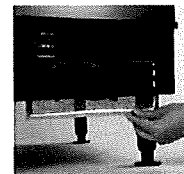

Simple, tool-free removal for quick access during routine cleaning and maintenance.